



Bam
bu
ga
lô

bangalô

duna

Art of Living



Bam
bu
ga
lô

DUNA Bungalow Launch



DUNA BANGALOW

An invitation to feel

The Duna bungalow is born from the union between **TECHNIQUE AND POETRY**. A project that celebrates bamboo as a living material and invites a new way of inhabiting — more integrated, sensitive, and conscious.

An **ARTISTIC AND HANDCRAFTED** project created by Bambugalô — a specialist in bamboo construction — in partnership with architect Júlia Gasparini, a reference in bioarchitecture projects.

Inspired by the simplicity and forms of nature, Duna represents the perfect blend between **COMFORT AND NATURAL IMMERSION** — a living space that welcomes, moves, and nurtures.

In just **60 DAYS**, the construction becomes reality: a healthy and profitable retreat, ideal for those who wish to invest in regenerative tourism and experiential lodging, or **ADD VALUE** to an existing business.

Duna is launched as a **LIMITED AND EXCLUSIVE EDITION**, handcrafted with soul and intention.
Only 10 units will be produced.





Bam
buga
lô

DUNA Bungalow Launch |



Duna is the result of a partnership between two references who share the same vision:
TO RECLAIM THE HUMAN ESSENCE OF ARCHITECTURE and promote the use of **NATURAL MATERIALS IN CONSTRUCTION.**



Bam
buga
lô

+

JULIA GASPARINI



Bambugalô is a construction company specialized in bamboo structures and cladding, known for its technical excellence and aesthetic sensitivity in residential, commercial, and signature projects. With over 60 completed projects, the brand has become synonymous with quality, innovation, and sustainability in Ceará — transforming bamboo into a symbol of elegance, comfort, and purpose.

Architect with international experience in Asia and South America, Júlia Gasparini researches the use of bamboo as both structure and poetic expression. Her work combines contemporary design, craftsmanship, and environmental awareness, creating spaces that move and inspire.





Bam
buga
lô

DUNA | Bangalô | Lançinh |



Comedor 3 - CASACOR Ceará 2023 - Fortaleza, CE



Clube Armonia - Aquiraz, CE



Restaurante Kumbuka - Cumbuco, CE

THE BANGALOW

Applied Bioarchitecture

With **BIOCLIMATIC** design strategies such as cross ventilation, natural lighting, and fluidity between indoor and outdoor spaces, the bungalow layout was designed to offer couples comfort and convenience.

- Total area: **46m²**
- Structure: **Bamboo**
- Floor: **Cumaru Deck**
- Walls: **Taipa de Mão (or hand-packed clay)**
- Roof: **Carnaúba Palm thatch**
- Frames and Furniture: **Muiracatiara Wood**

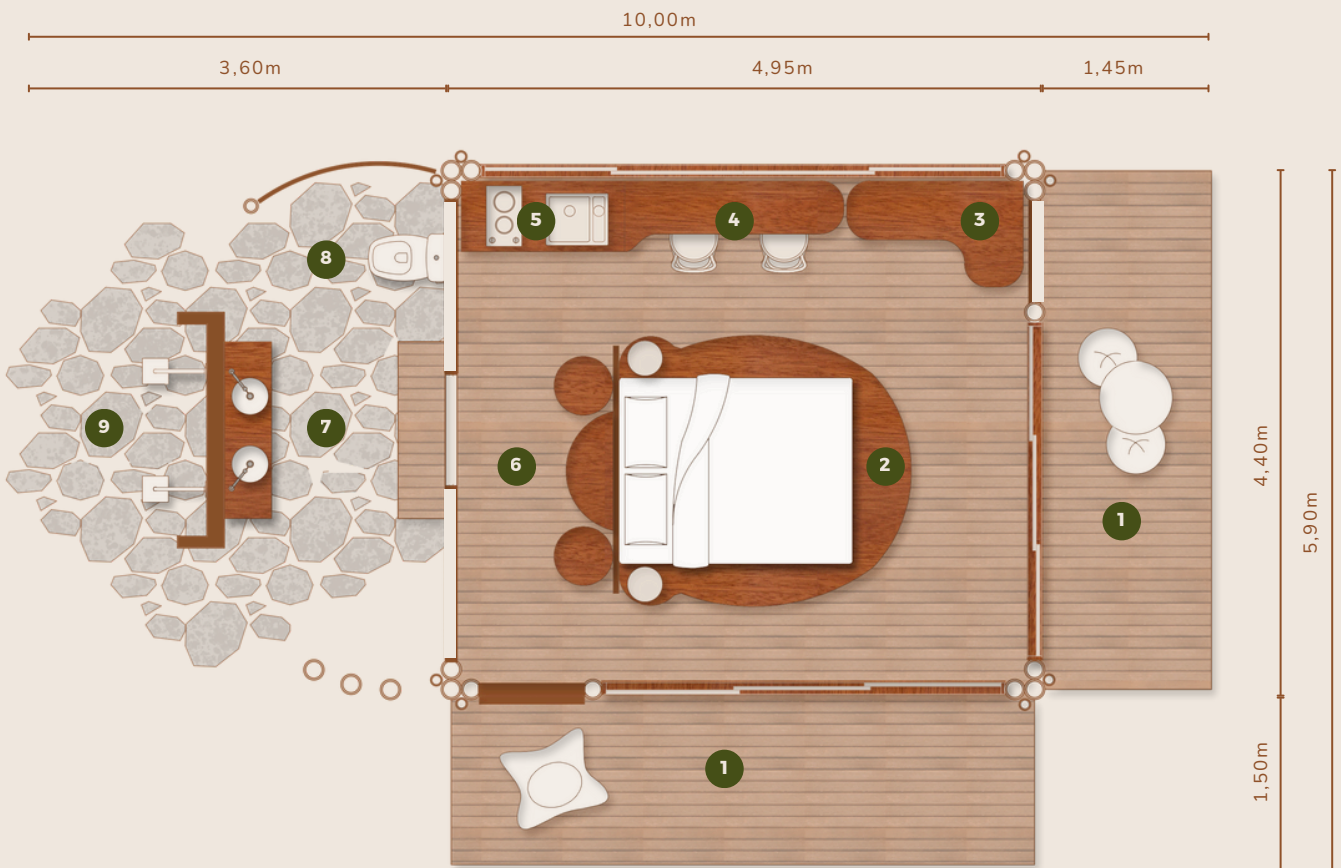

1- Balconies;
2- Queen bed;
3- Couch;
4- Table;
5- Kitchen;

6- Closet;
7- Sink;
8- Sanitary;
9- Shower;

INTERIOR AREA 21,7m²
EXTERIOR AREA 10,4m²
BALCONIES 13,9m²



- cross ventilation

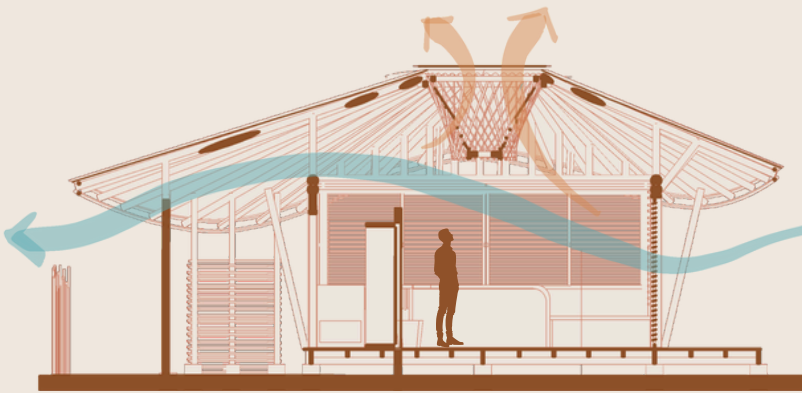
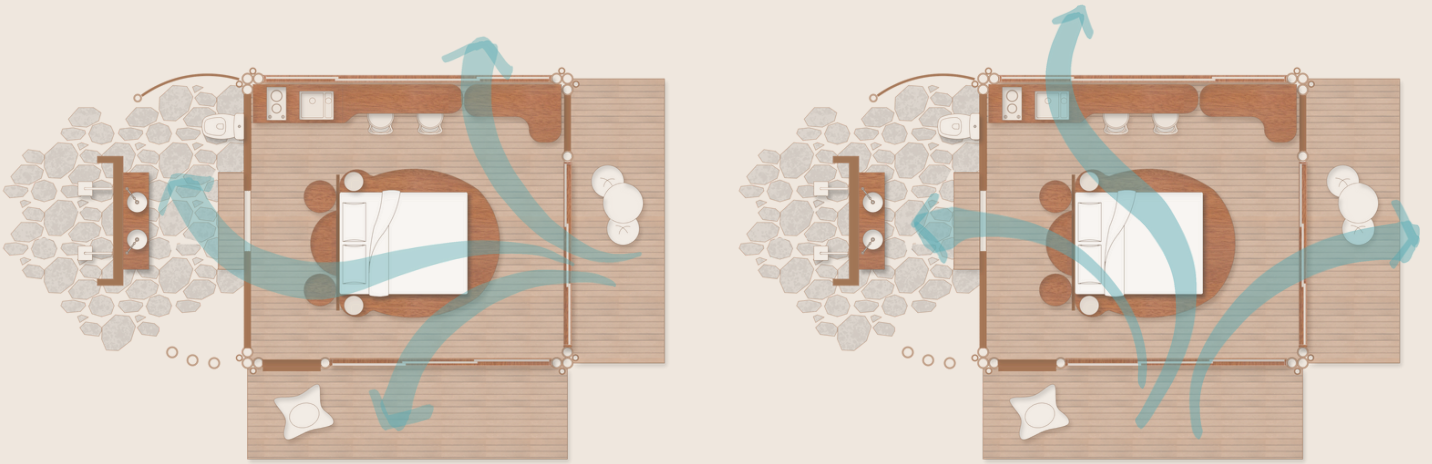

- cross ventilation

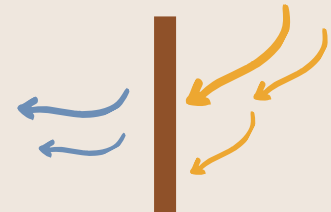

- thermal inertia

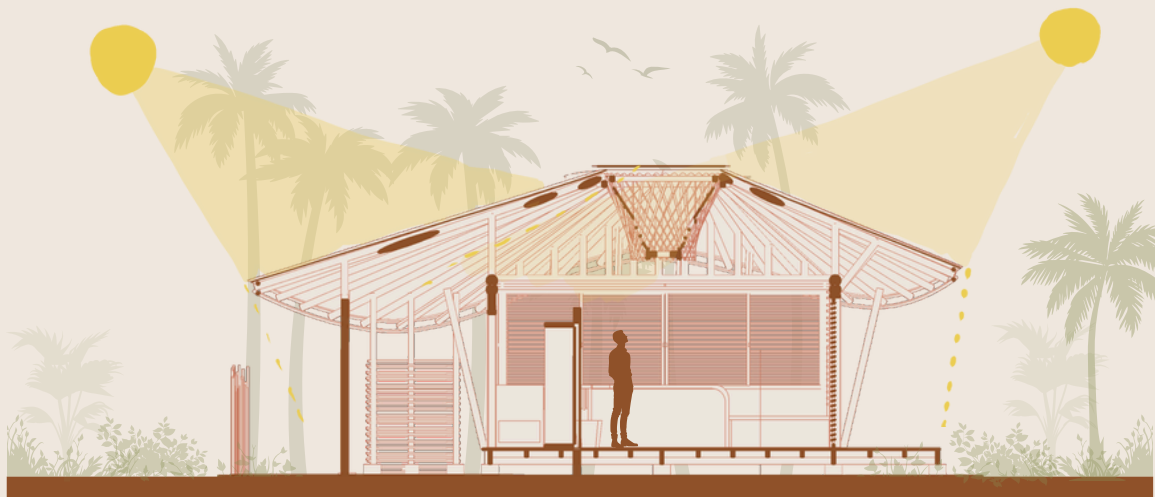

- wide eaves
- integration with nature
- integrated lighting



THE BANGALOW

Attention to Every Detail

ROOM

central bed designed exclusively for the bungalow and closet space

LIVING ROOM

dedicated work desk and cozy sofa for reading and relaxation.

KITCHEN

equipped with minibar, microwave, cooktop, and spacious sink for practicality

BATHROOM

open-concept design with two showers and two sinks for comfort

BALCONIES

spacious areas for conversation and contemplation



Queen Bed



Outdoor bathroom



Equipped kitchen



Sound and lighting with automation system



Dedicated work area



Panoramic views of the landscape





Bam
buga
lô

DUNA - Bungalow Launch

A COMPLETE SOLUTION

FROM ART TO TECHNIQUE, FROM DREAM TO DELIVERY

Created to simplify the process for those who want to invest in unique accommodations or expand a tourism business.

The result is architecture of excellence, delivered with financial predictability and peace of mind.



Exclusive Product



Architectural and Design Solutions Included



Delivery Time: 60 days



Specialized Assembly Team



Turnkey Solution



Technical Supervision



Natural and Renewable Materials



Cost and Schedule Forecast





Bam
bugalô

DUNA Bungalow Launch

WE TAKE CARE OF EVERYTHING FOR YOU



AUTHORED DESIGN

With the signature of Júlia Gasparini, applying principles of bioarchitecture and neuroarchitecture.



PERSONALIZATION

Options for finishes, layouts, and integration with surroundings.



OPTIMIZED LOGISTICS*

Safe transport and construction in up to 60 days.



QUALITY MATERIALS

High-quality treated bamboo, hardwood, fire-resistant thatch, and custom furniture.



COMPLETE EXECUTION

Skilled labor, ART (technical responsibility), technical supervision, and fine finishing.

**Services with costs to be defined according to construction site location, during the final contract stage.*





**Bam
buga
lô**

DUNA Bungalow Launch |

YOUR WAY, IN YOUR PLACE

Technical Support and Customization



TOPOGRAPHY STUDY

On-site visit and assessment to choose the best foundation solutions.



SITE PLANNING

Layout of bungalows on the land considering solar orientation, wind direction, pedestrian flow, rainwater drainage, and views.



CONSTRUCTION DETAILS

Flexibility in choosing details according to the project style, available materials, and local techniques.



FINISHES AND LAYOUTS

Adaptable finishes and layout options according to each site's needs and intended uses.

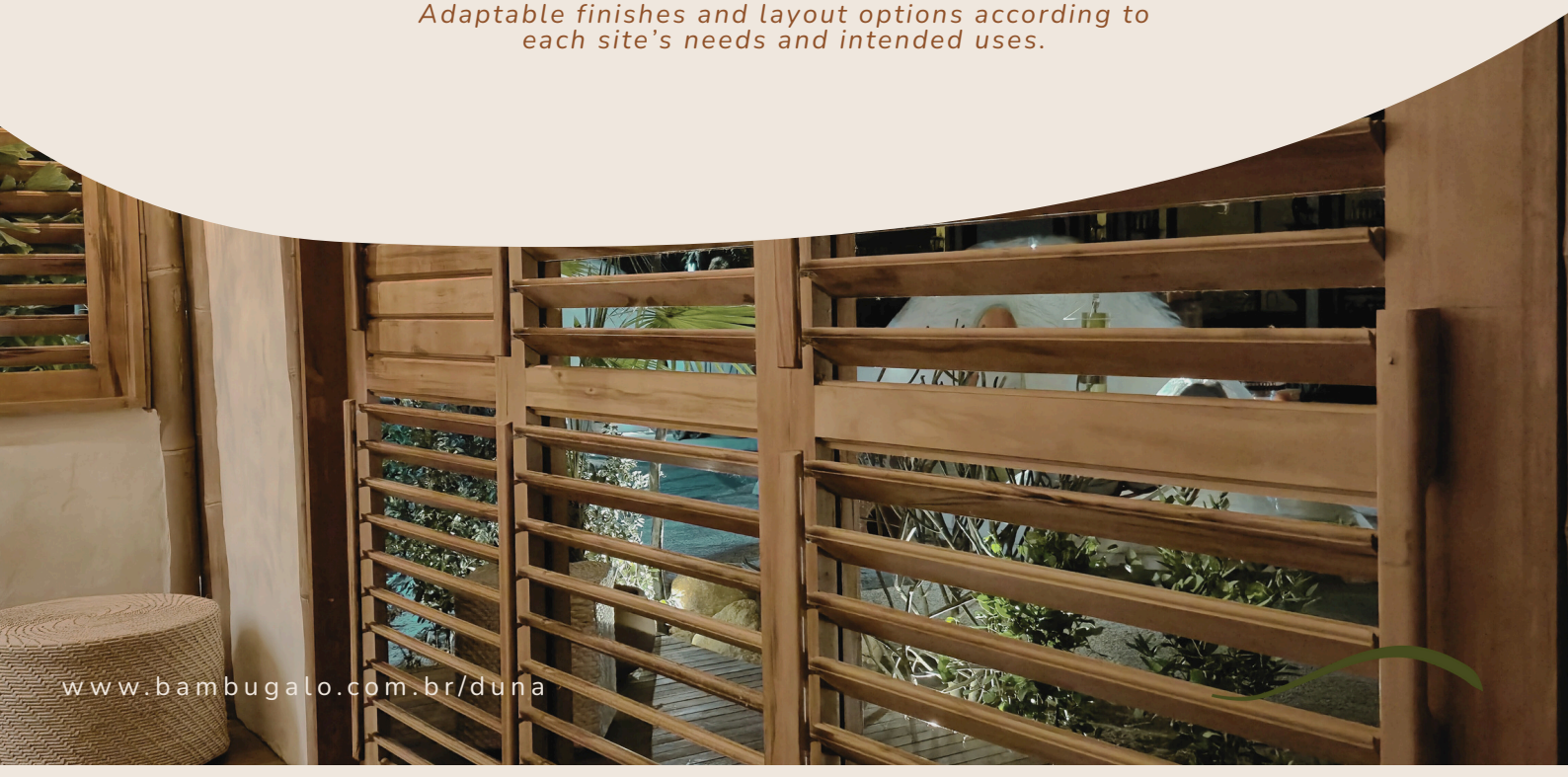



MATERIALS

Guaranteed Quality



STRUCTURAL BAMBOO

Treated with boron solution for insect protection.



CARNAUBA THATCH

Properly harvested and treated for fire resistance.



HARD WOOD

High-quality wood ensuring durability and strength.



EARTH / CLAY

Walls well-structured and executed according to the best practices in the field.



ECOLOGIC BRICK

Self-supporting bathroom walls ensuring stability.



NATURAL FIBERS

Upholstery and decor use natural fibers and fabrics aligned with guest well-being.





Bam
buga
lô

DUNA Bungalow Launch |





Bam
buga
lô

DUNA Bungalow Launch |

INVESTMENT

Architecture that enchants and generates income.

Starting from **R\$295,000** per unit*, the Duna bungalow can bring significant return to your enterprise.



SIMPLE BUNGALOW

Only the **external structure**.



FURNISHED BUNGALOW

with **custom-designed** furniture.



READY TO USE

fully equipped with **high-end partner products**.



**For more information about prices, payment conditions, delivery options, discounts, and other details, please contact our team.*

MEET OUR PARTNERS



www.bambugalo.com.br/duna





A PROFITABLE BUSINESS

More than a bungalow — an investment

Exotic accommodations tend to charge **2.5x to 5x** higher daily rates than conventional lodgings, with **higher occupancy rates** as well.

Rates vary according to factors such as **architectural impact, location, landscape, available services, and regional attractions.**

ADR

Average Daily Rate (R\$)

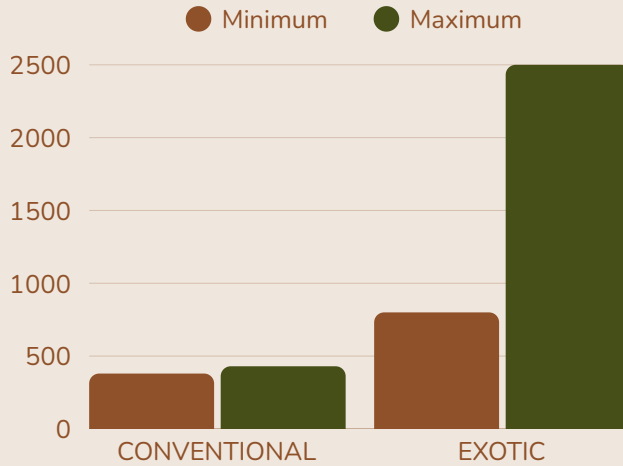

source: FOHB 2023/2025, Omnibees Fortaleza 2024

Occupancy

Rate (%)

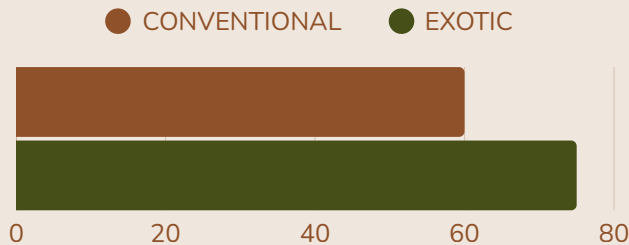

source: FOHB 2023/2025, Omnibees Fortaleza 2024





SCENARIOS

The opportunity in numbers

	CONVENTIONAL	EXOTIC (DUNA)			
ADR (R\$) Average Daily Rate per unit	400	800	1200	1500	2000
REVPAR (R\$) Revenue per Room (ADR x occupancy rate)	280	560	840	1050	1400
ROI ANUAL (%) Annual Return	15,3	17,5	26,3	32,8	43,7
PAYBACK (Years)	6,5	5,7	3,8	3,0	2,5

Considering:
 Occupancy Rate 70%; Net Profit 30%;
 Conventional Cost R\$200,000; Duna Cost R\$350,00;



While the **average net profit margin** for a conventional bungalow ranges between 15% and 25%, an exotic bungalow can reach **up to 45%**.

REASONS

- High ADR without proportional cost increase
- More income with fewer units (lower staff needs)
- Potential for complementary revenue
- Less dependence on OTAs (such as Booking or Airbnb)





Bambu
lô

DUNA Bungalô



WHY INVEST NOW?

Exotic bungalows generate REVPAR **up to 3x higher** than conventional inns.

While a traditional bungalow may take 6.5 years to pay off, the Duna bungalow **can pay off up to 3x faster**.

Even with a higher construction cost, Duna can yield **up to 5x more profit** and achieve a ROI up to **2.5x greater**.

14,7%

Tourism growth rate in Ceará in March 2025

73,8%

Average hotel occupancy rate in the 1st half of 2025, with peaks above 80% during holidays and high season.

Sources:

SETUR-CE (Secretaria do Turismo do Ceará)

IPECE (Instituto de Pesquisa e Estratégia Econômica do Ceará)



CONTACT US



(85) 8888-0942



CONTATO@BAMBUGALO.COM



@BAMBUGALO



WWW.BAMBUGALO.COM.BR/DUNA

ACCESS THE
INTEREST FORM



official partners

GRUPO
ELETTROMECC

DECA

aldo^{zz}
colchões



SECRETARIA DA PROTEÇÃO SOCIAL

LAMPER



Studio Suel DESIGN
ARTE
MADEIRA



FINA
CASA
REVESTIMENTOS

smart
work

